

LM-A TYPE

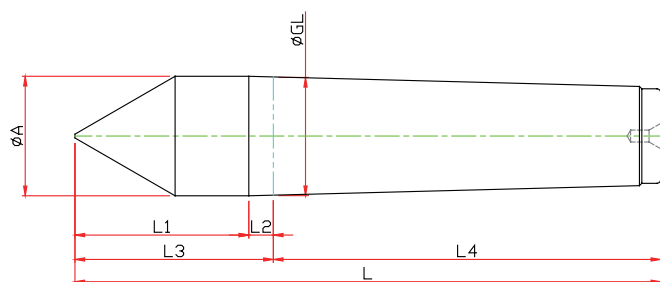

unit:mm/kg

Model	Morse Taper	Dimension							Run out (inch)
		GL	A	L1	L2	L3	L4	L	
LM-1A	NO.1	12,065	12,2	25	3,5	28,5	53,5	82	0,00011811
LM-2A	NO.2	17,780	18	31	5	36	64	100	0,00011811
LM-3A	NO.3	23,825	24	39	5	44	81	125	0,00011811
LM-4A	NO.4	31,267	31,6	46	6,5	52,5	102,5	155	0,00011811
LM-5A	NO.5	44,399	44,7	64	6,5	70,5	129,5	200	0,00011811
LM-6A	NO.6	63,348	63,8	80	8	88	182	270	0,00019685
LM-7A	NO.7	83,058	83,6	105	10	115	250	365	0,00019685

※SPECIAL sizes or dimensions are available with quick turnaround

LM-C TYPE

※ Carbide Type

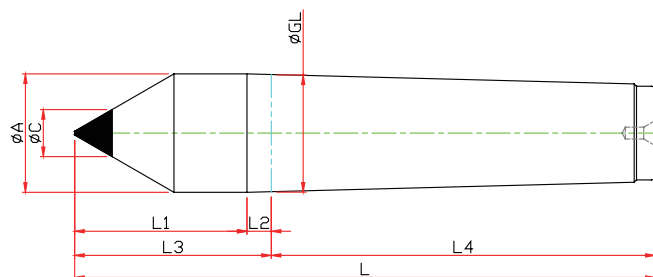

unit:mm/kg

Model	Morse Taper	Dimension								Run out (inch)
		GL	A	L1	L2	L3	L4	C	L	
LM-1C	NO.1	12,065	12,2	25	3,5	28,5	53,5	7	82	0,00011811
LM-2C	NO.2	17,780	18	31	5	36	64	7	100	0,00011811
LM-3C	NO.3	23,825	24	39	5	44	81	10	125	0,00011811
LM-4C	NO.4	31,267	31,6	46	6,5	52,5	102,5	14	155	0,00011811
LM-5C	NO.5	44,399	44,7	64	6,5	70,5	129,5	18	200	0,00011811
LM-6C	NO.6	63,348	63,8	80	8	88	182	25	270	0,00019685
LM-7C	NO.7	83,058	83,6	105	10	115	250	30	365	0,00019685

※SPECIAL sizes or dimensions are available with quick turnaround